

**1** Large playscape that goes above and beyond the current accessibility standards.

**2** Brushy Creek Village has several play buildings and street signs. The skills learned can be utilized in real world community settings.

**3** Rock Band Pod includes several outdoor instruments such as drums, xylophones, and bells.

**4** Sensory Fun Pod is a fun, learning pod with a low sitting wall made of several different materials, learning panels and an accessible sand play area.

**5** Island Retreat is designed for children needing a quieter, calmer play experience. Play equipment is spaced further apart and the pod is more remotely located.

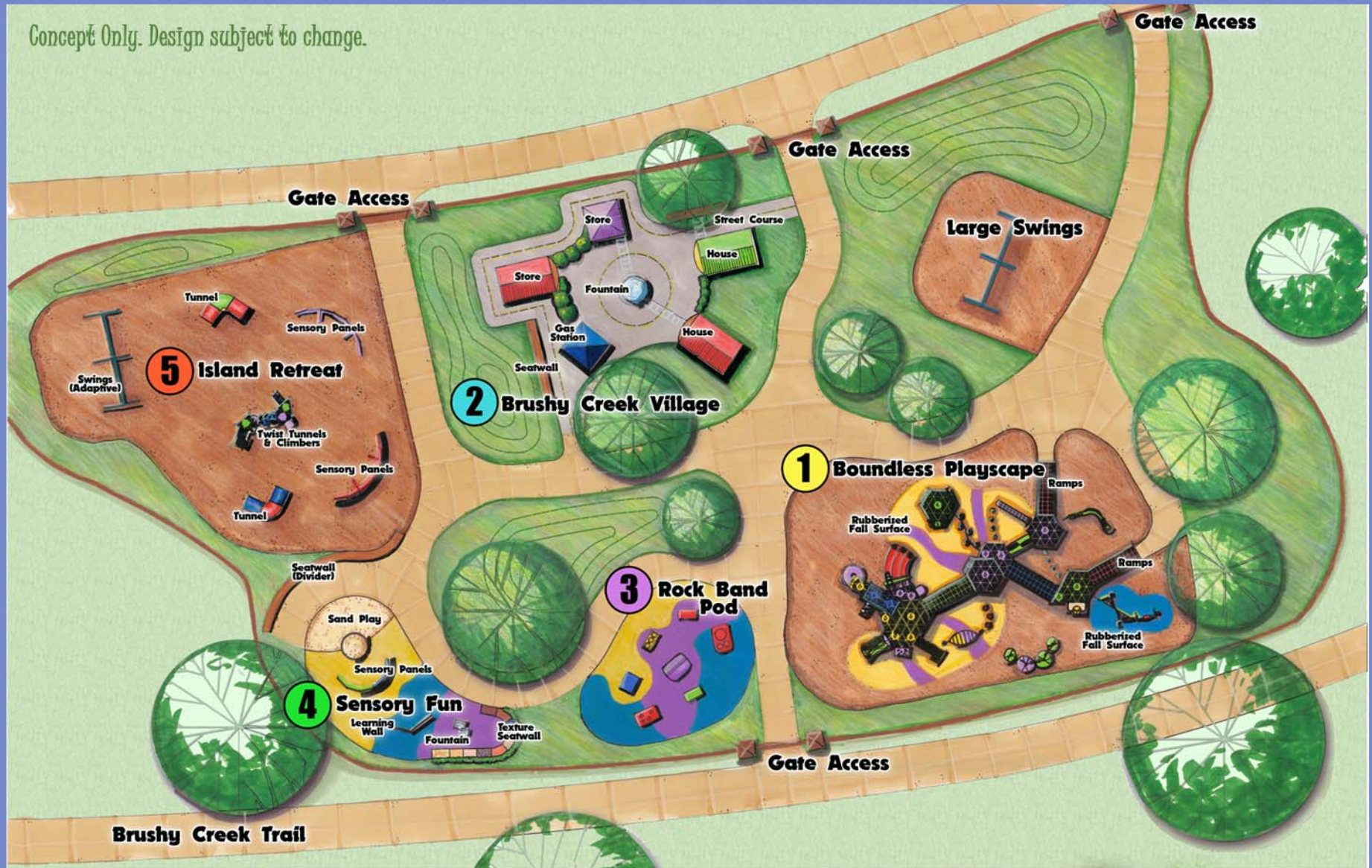

# Play for All Abilities

